

**CONSTRUCTION ACTIVITIES:**

Two-week construction window for contractor to repair existing sewer under construction contract warranty.

**DETOUR OCTOBER 21 - NOVEMBER 4**

- 1) The 88th Ave crosswalk on the west side of Sheridan Blvd will be closed for the public's safety.
- 2) The 88th Ave crosswalk on the east side of Eaton St will be open. Detour signage will direct bicycles and pedestrians to open crosswalks.
- 3) Traffic will be congested due to detours and lane closures.
- 4) Exercise caution and follow traffic signals and detour signage for your own and the public's safety.

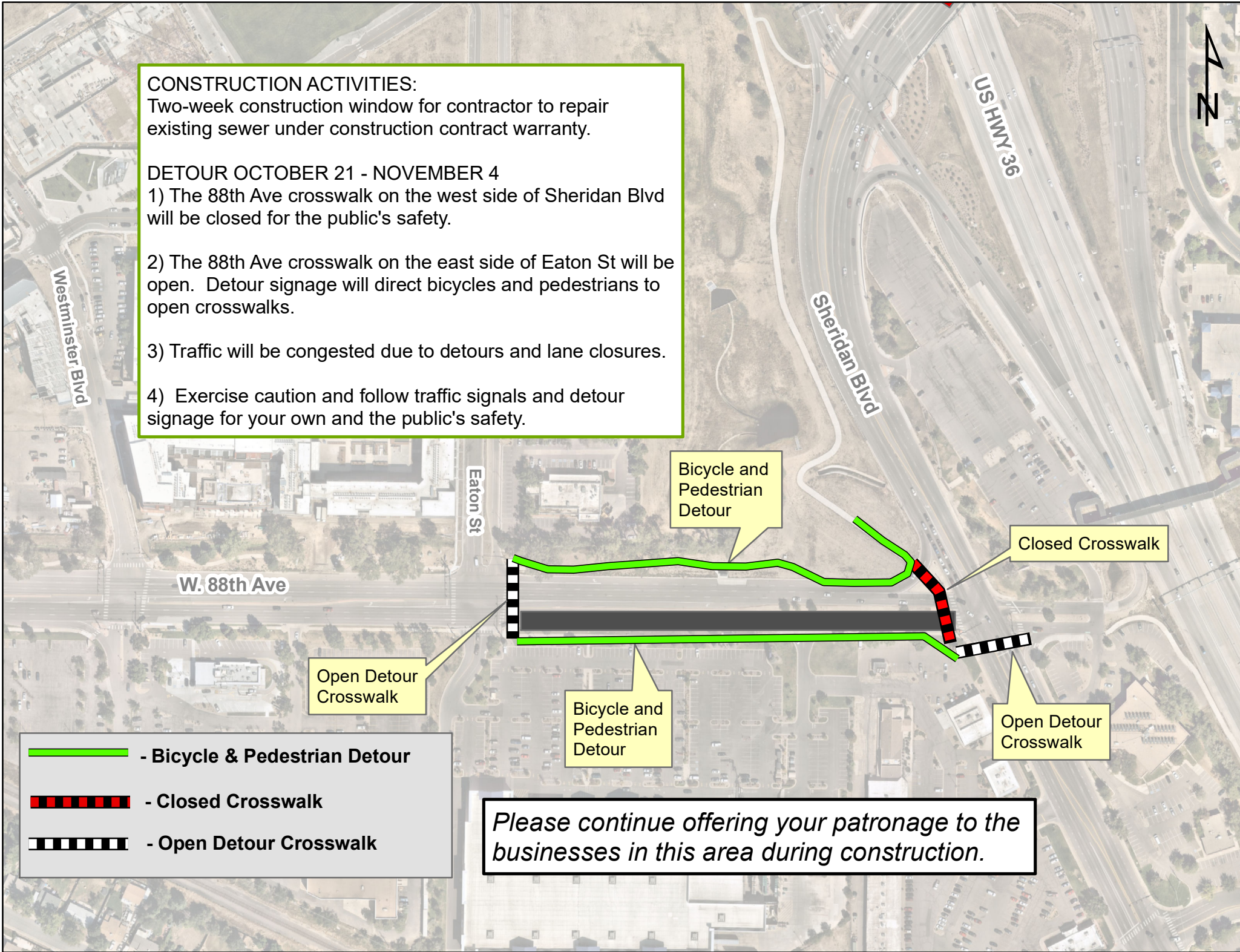



Bicycle and Pedestrian Detour

Closed Crosswalk

Open Detour Crosswalk

Bicycle and Pedestrian Detour

Open Detour Crosswalk

-  - Bicycle & Pedestrian Detour
-  - Closed Crosswalk
-  - Open Detour Crosswalk

*Please continue offering your patronage to the businesses in this area during construction.*

